

STANDPIPE (1)

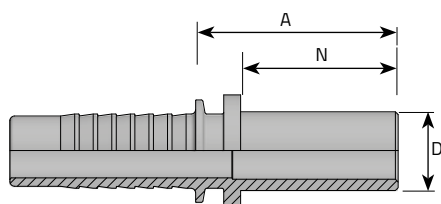

ERMETO DIRITTO
EMBOUT LISSE DROIT
ROHRSTUTZEN BEL - BES
ESPIGA LISA RECTA

Code	Tube			Thread	Dimensions			Pressure	
	D.N.	Hose	Diam		D	N	A	Bar	Psi
	Inch		mm		mm	mm	mm		
PDL0306	-3	3/16"	4.8		6	24	30	415	6019
PDL0308	-3	3/16"	4.8		8	24	30	415	6019
PDL0406	-4	1/4"	6.4		6	22.5	30.5	320	4641
PDL0408	-4	1/4"	6.4		8	23	30.5	450	6526
PDL0410	-4	1/4"	6.4		10	25	32	450	6526
PDL0412	-4	1/4"	6.4		12	25	32	450	6526
PDL0508	-5	5/16"	7.9		8	23	30	-	
PDL0510	-5	5/16"	7.9		10	25	32	350	5076
PDL0512	-5	5/16"	7.9		12	25	32	350	5076
PDL0610	-6	3/8"	9.5		10	25.5	33	330	4786
PDL0612	-6	3/8"	9.5		12	25	32.5	445	6454
PDL0614	-6	3/8"	9.5		14	28	35.5	445	6454
PDL0615	-6	3/8"	9.5		15	25.5	33	250	3626
PDL0812	-8	1/2"	12.8		12	25	33	-	
PDL0814	-8	1/2"	12.8		14	28	36	275	3988
PDL0815	-8	1/2"	12.8		15	25.5	33.5	250	3626
PDL0816	-8	1/2"	12.8		16	31	39	415	6019
PDL0818	-8	1/2"	12.8		18	27	35.5	160	2320

STANDPIPE (2)

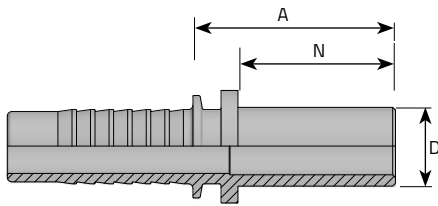

ERMETO DIRITTO
EMBOUT LISSE DROIT
ROHRSTUTZEN BEL - BES
ESPIGA LISA RECTA

Code	Tube			Thread	Dimensions			Pressure	
	D.N.	Hose Inch	Diam mm		D mm	N mm	A mm	Bar	Psi
PDL1018	-10	5/8"	16		18	28	36	160	2320
PDL1020	-10	5/8"	16		20	35	43.5	350	5076
PDL1022	-10	5/8"	16		22	29	38	160	2320
PDL1218	-12	3/4"	19		18	26	34.5	160	2320
PDL1220	-12	3/4"	19		20	35	44	215	3118
PDL1222	-12	3/4"	19		22	29.5	38	160	2320
PDL1225	-12	3/4"	19		25	41	51	350	5076
PDL1625	-16	1"	25.4		25	39.5	50	165	2393
PDL1628	-16	1"	25.4		28	30.5	41	100	1450
PDL1630	-16	1"	25.4		30	43.5	54	250	3626
PDL2030	-20	1.1/4"	31.8		30	43	54.5	210	3046
PDL2035	-20	1.1/4"	31.8		35	35.5	46.5	100	1450
PDL2038	-20	1.1/4"	31.8		38	48	60	210	3046
PDL2438	-24	1.1/2"	38.1		38	48	60	170	2466
PDL2442	-24	1.1/2"	38.1		42	36	47	100	1450